

(222)

State of South Carolina Pursuant to a warrant from John Thomas Esq. Com. of Locations dated 26th day of Nov. 1784. I have admeasured and laid out unto Joshua Saxon a Plantation or tract of land containing 90 acres situate in Ninety six District on Peedy River bounded W. on Daniel McClains land & land laid out N.W. on land laid out unknown below the ancient Boundary line, & has the such shape & marks as the annexed plat Represents. Surveyed 22nd of Nov. 1784

Recorded the 6th of Dec. 1784

J. Thomas Esq.
Com. of Locations

Delivered to Capt. Saxon

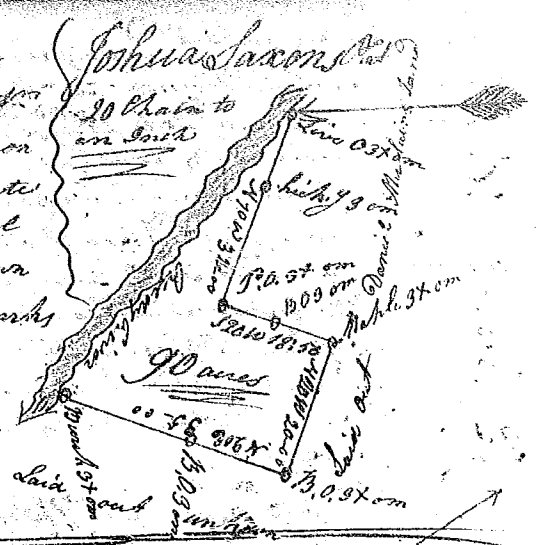

State South Carolina Pursuant to a Warrant from John Thomas Esq. Com. of Locations dated 26th 1784. I have admeasured & laid out unto Sam. Saxon a Plantation or tract of land containing 910 acres, situate in 96 District below the line; on a branch of Peedy River bounded N.W. on Goodwins & Williams arlands N.E. on Wm. Williams land & Sam. E. Neighbors & Joseph Shalletts S.W. on land laid out unknown, & hath such shape and marks as the above plat Represents. Surveyed this 23rd day of Nov. 1784

Recorded the 6th day of December 1784

Delivered to Capt. Saxon

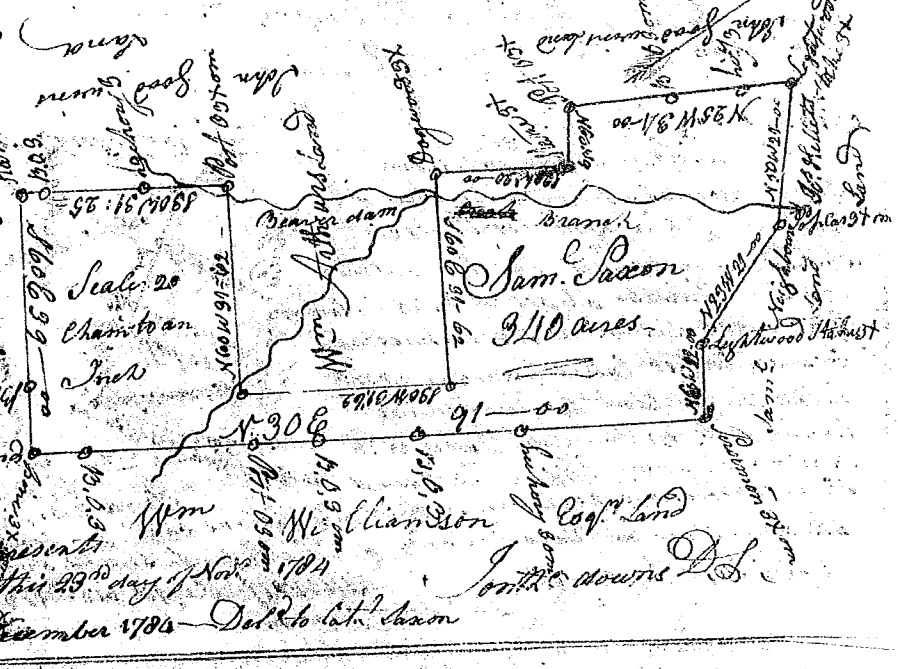

State of South Carolina Pursuant to a warrant from John Thomas Esq. Com. of Locations dated 26th 1784. I have admeasured & laid out unto Sam. Saxon a Plantation or tract of land containing 150 acres situate in 96 Dis. Below the ancient Boundary line on a branch of Peedy River called the Peedy fork. Bounded N.E. on Alex. Mezards land W. on a big Survey S. on Phel Linnings land S.W. on Sam. Saxon land & hath such shape & marks as the annexed plat Represents. Surveyed 23rd of Nov. 1784

Recorded the 6th of Dec. 1784

Delivered to Capt. Saxon

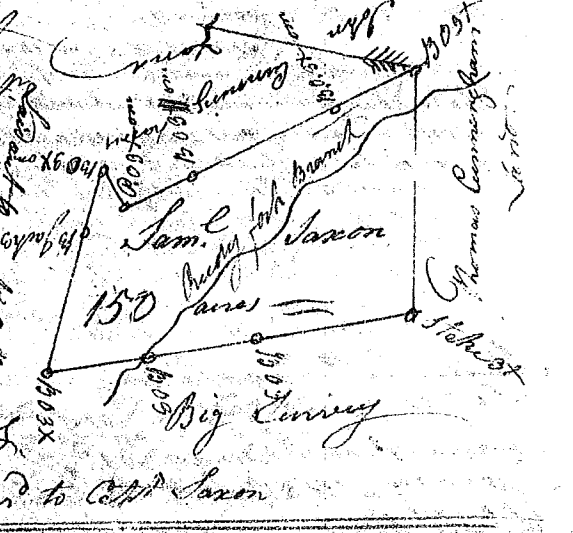

State of S. Carolina Pursuant to a warrant from John Thomas Esq. Com. of Locations dated 26th 1784. I have admeasured & laid out unto Sam. Saxon a Plantation or tract of land containing 150 acres situate in 96 Dis. Below the ancient Boundary line on a branch of Peedy River bounded by J. Dumasys land S. by Mays Peedy Butlers & set off there on vacant land and hath such shape and marks as the annexed plat Represents. Surveyed the 24th day of Nov. 1784

Recorded 6th Dec. 1784

Delivered to Capt. Saxon

